

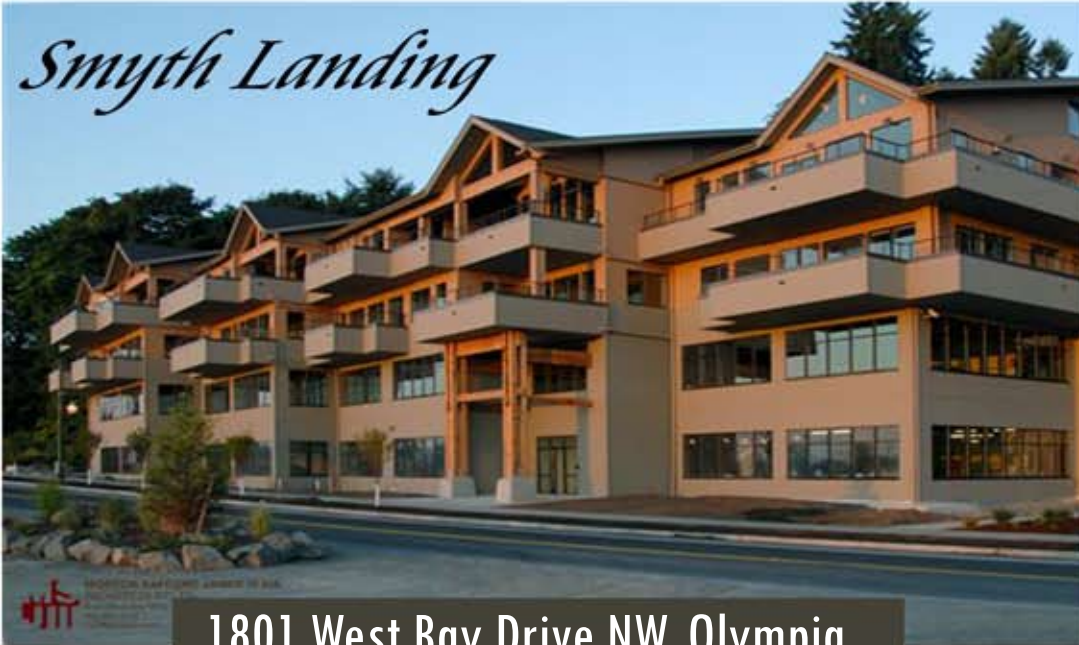

# FOR SALE or LEASE

Class "A" Waterfront Condominium Offices

[www.rants-group.com](http://www.rants-group.com)



*Smyth Landing*

1801 West Bay Drive NW, Olympia



First Floor Available:

- Unit 1B - 589 rsf
- Unit 2 - 2,011 rsf
- Unit 3 - 2,387 rsf
- Unit 4A - 2,015 rsf
- Unit 4B - 961 rsf



- For Sale at \$210.00 psf
- For Lease at \$25.50 psf
- Fully Serviced, Excluding Janitorial
- \$30 psf Tenant Improvement Allowance

Variety of Floor Plan Options - You Choose! • Pre-Arranged Financing for Qualified Buyers!  
Beautiful Setting, Great Location, Good Parking • New Construction • Close to Downtown Olympia

**The Rants Group**  
724 Columbia St. NW, Suite 200  
Olympia, WA 98501

Phone (360) 943-8060  
Fax (360) 943-9368  
[www.rants-group.com](http://www.rants-group.com)

**Shelley Foltz**  
Commercial Agent  
[shelley@rants-group.com](mailto:shelley@rants-group.com)



This information, while obtained from sources we deem reliable, is not guaranteed. It is provided without any representation, warranty or guarantee, expressed or implied as to its accuracy. Prospective buyer or tenant should conduct an independent investigation and verification of all matters deemed to be material, including, but not limited to, statements of income and expenses. Consult your attorney, accountant, or other professional advisor.



# FOR LEASE/FOR SALE INFORMATION

## SMYTH LANDING - 1801 WEST BAY DRIVE NW

### Smyth Landing

For Lease



**Smyth Landing**  
1801 West Bay Drive NW  
Olympia WA 98502  
Thurston County

#### Building Information

Total Building SF: 23,557  
Total Office SF: 10,943  
Largest Contiguous SF: 10,943  
Year Built: 2006  
Sprinklers: Yes  
Construction Type: Concrete, Glass, Stucco  
Security System: Yes  
Building Class: A  
# of Buildings: 1  
# of Floors: 4  
# of Units: 4  
# of Elevators: 1  
A/C: Yes

#### Location

Market Area: Olympia  
Building Status: Existing  
[Property Website Link](#)

#### Property Information

Tax ID #s: 74810000100  
Total Land SF: 217,800  
Acres: 5.00  
Zoning: Urban Waterfront  
Investment: No  
Owner User: Yes

#### Informational Links

[Flyer](#) [Map](#) [Demographics](#) [Building Detail](#) [Print](#) [Building History](#)

#### Space Information (Listing # 457904)

<b>Asset Class:</b> Office	<b>Days on Mkt:</b> 278	<b>Agent:</b> <a href="#">Shelley Foltz</a>
<b>Lease Type:</b> Full Service	<b>Rent Min:</b> \$ 25.50 /sf	<b>Email:</b> <a href="mailto:shelley@rants-group.com">shelley@rants-group.com</a>
<b>Status:</b> Available	<b>Rent Max:</b> \$ 25.50 /sf	<b>Office Phone:</b> (360) 943-8060
<b>Availability:</b> Vacant	<b>Avall SF:</b> 7,374	<b>Phone:</b> (360) 943-8060
<b>Date Avail:</b> 12/28/2009	<b>Divide To SF:</b> 961	<b>Company:</b> Rants Group, The
<b>Floor:</b> 1st		<b>Last Modified:</b> 4/21/2010
<b>Entire Floor:</b> No		<b>LOC:</b> 3%
<b>Sub Lease:</b> No		<b>LOC Excl:</b> No
<b>Move In:</b> Immediately		

#### Listing Broker Comments:

Premiere office space with views of Budd Inlet and close to downtown & the westside. Free surface parking, high speed connectivity. 4 spaces (961sf, 2,011sf, 2015sf, 2,287sf) office condo units for lease (can be combined) at \$25.50 fully serviced, excluding janitorial. Includes \$30.00/psf T.I. allowance with variety of floor plan options.

#### Public (Internet) Comments:

##### Smyth Landing - Premiere Offices

Premiere office space with views of Budd Inlet and close to downtown & the westside. Free surface parking, high speed connectivity. 4 spaces (961sf, 2,011sf, 2015sf, 2,287sf) office condo units for lease (can be combined) at \$25.50 fully serviced, excluding janitorial. Includes \$30.00/psf T.I. allowance with variety of floor plan options.

#### Search Tags:

#### For Sale Information

Listing #	Status	Price	Asset Class	Office	Broker	Phone
445200	Available	\$1,548,540	Office	Rants Group, The	Shelley Foltz	360-943-8060

**The Rants Group**  
724 Columbia St. NW, Suite 200  
Olympia, WA 98501

Phone (360) 943-8060  
Fax (360) 943-9368  
[www.rants-group.com](http://www.rants-group.com)

**CONTACT:**  
**Shelley Foltz**  
[shelley@rants-group.com](mailto:shelley@rants-group.com)

# FLOOR PLAN

## SMYTH LANDING - 1801 WEST BAY DRIVE NW

  
**BASIS OF BEARINGS:**  
 CITY OF OLYMPIA B.L.A. NO. 20A-07-0010L  
 CITY OF OLYMPIA VERTICAL DATUM

  
 GRAPHICAL SCALE: 1" = 10'

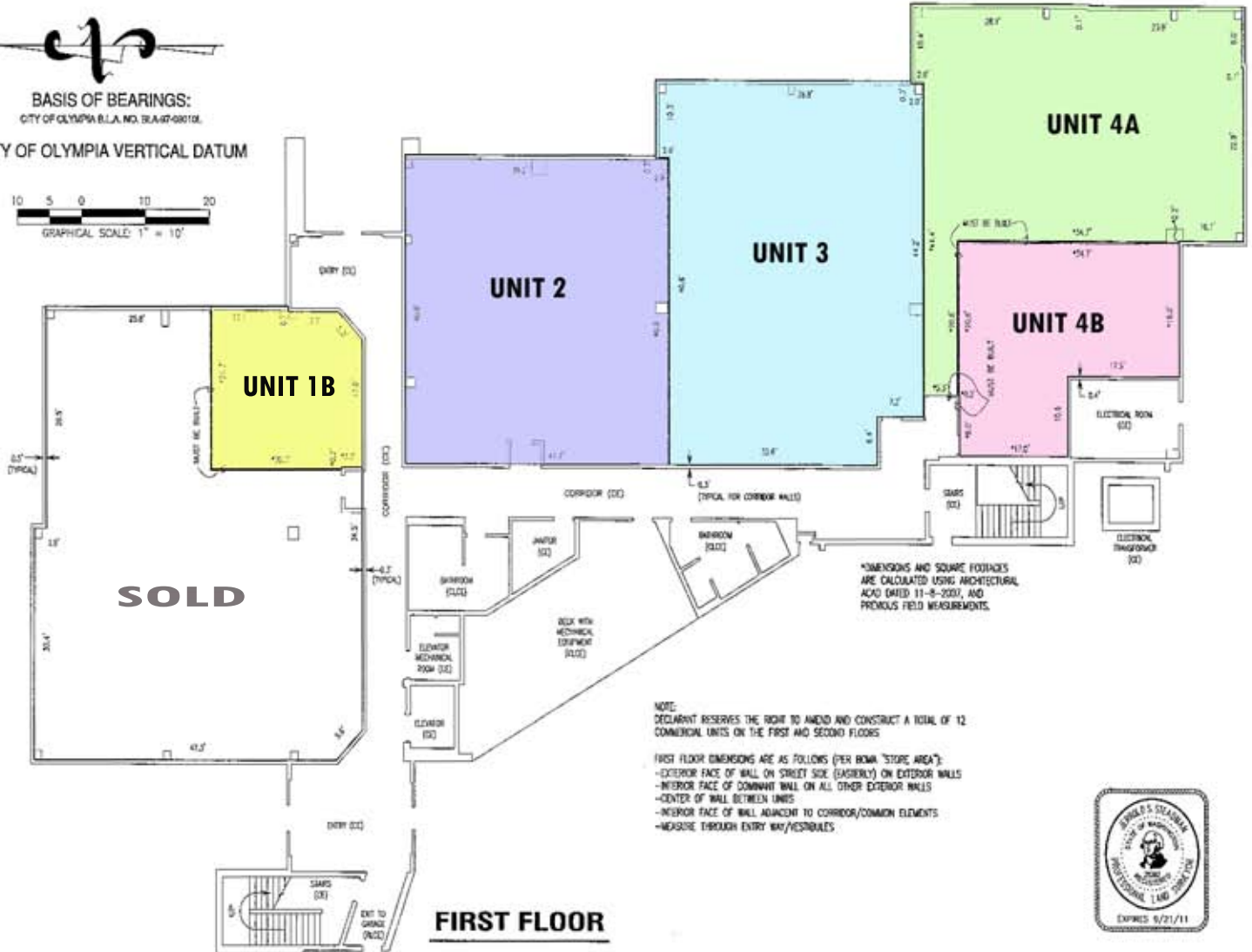

**The Rants Group**  
 724 Columbia St. NW, Suite 200  
 Olympia, WA 98501

Phone (360) 943-8060  
 Fax (360) 943-9368  
[www.rants-group.com](http://www.rants-group.com)

**CONTACT:**  
 Shelley Foltz  
[shelley@rants-group.com](mailto:shelley@rants-group.com)

This information, while obtained from sources we deem reliable, is not guaranteed. It is provided without any representation, warranty or guarantee, expressed or implied as to its accuracy. Prospective buyer or tenant should conduct an independent investigation and verification of all matters deemed to be material, including, but not limited to, statements of income and expenses. Consult your attorney, accountant, or other professional advisor.

