



FOR SALE. FOR LEASE.  
FOR YOU.

# FOR LEASE

Class "A" Waterfront Professional Office/Condo

[www.rants-group.com](http://www.rants-group.com)

## *Smyth Landing*



*1801 West Bay Drive NW, Olympia*

### Suite 207 & 208

*5,874 square feet - Divisible to 2,578 sf and 3,296 sf*

*For lease at \$22.00/psf*

*Fully serviced, excluding janitorial*

*Beautiful, Class "A" building with superior office finish*

*Amazing waterfront view*



Shelley Foltz, Commercial Broker  
[shelley@rants-group.com](mailto:shelley@rants-group.com)



**PHONE: 360.943.8060 • FAX: 360.943.9368 • 724 Columbia Street NW, #200, Olympia, WA 98501**

This information, while obtained from sources we deem reliable, is not guaranteed. It is provided without any representation, warranty or guarantee, expressed or implied as to its accuracy. Prospective buyer or tenant should conduct an independent investigation and verification of all matters deemed to be material including, but not limited to, statements of income and expenses. Consult your attorney or other professional advisor.

### Smyth Landing

For Lease



(c)CBA

#### Sustainability/Green Building

LEED Cert: No  
Energy Star Cert: No

**Smyth Landing**  
1801 West Bay Drive NW  
Olympia WA 98502  
Thurston County

#### Building Information

Total Building SF: 23,557  
Total Office SF: 10,943  
Largest Contiguous SF: 10,943  
Year Built: 2006  
Sprinklers: Yes  
Construction Type: Concrete, Glass, Stucco  
Security System: Yes  
Building Class: A  
# of Buildings: 1  
# of Floors: 4  
# of Units: 4  
# of Elevators: 1  
A/C: Yes

#### Location

Market Area: Olympia  
Building Status: Existing

[Property Website Link](#)

#### Property Information

Tax ID #s: 74810000100  
Total Land SF: 217,800  
Acres: 5.00  
Zoning: Urban Waterfront  
Investment: No  
Owner User: No

#### Space Information for Suite 207/208 (Listing # 502007)

<b>Asset Class:</b> Office	<b>Days on Mkt:</b> 3	<b>Agent:</b> <a href="#">Shelley Foltz, CCIM</a>
<b>Lease Type:</b> Full Service	<b>Rent Min:</b> \$ 22.00 \$/sf/yr	<b>Email:</b> <a href="mailto:shelley@rants-group.com">shelley@rants-group.com</a>
<b>Status:</b> New	<b>Rent Max:</b> \$ 22.00 \$/sf/yr	<b>Phone:</b> (360) 943-8060
<b>Availability:</b> Available	<b>Avail SF:</b> 5,874	<b>Company:</b> Rants Group, The
<b>Date Avail:</b> 1/13/2012	<b>Vacant SF:</b> 5,874	<b>Office Phone:</b> (360) 943-8060
<b>Floor:</b> 2nd	<b>Divide To SF:</b> 2,578	<b>LOC:</b> 3.0%
<b>Suite:</b> 207/208		<b>Exclusions:</b> No
<b>Entire Floor:</b> No		<b>Last Modified:</b> 1/16/2012
<b>Sub Lease:</b> No		
<b>Move In:</b> Immediately		

#### Listing Broker Comments:

Premiere office space for lease. Total space is 5,874 sf. Suite 207 = 2,478 sf and Suite 208 = 3,296 sf. Currently combined, but easily divisible. Offered at \$22.00/psf, fully serviced, excluding janitorial. This 2nd floor space has superior build out with amazing waterfront view of Budd Inlet. Free surface parking and high speed connectivity. Close to downtown Olympia.

#### Public Comments:

##### Smyth Landing - Premier office

Premiere office space for lease. Total space is 5,874 sf. Suite 207 = 2,478 sf and Suite 208 = 3,296 sf. Currently combined, but easily divisible. Offered at \$22.00/psf, fully serviced, excluding janitorial. This 2nd floor space has superior build out with amazing waterfront view of Budd Inlet. Free surface parking and high speed connectivity. Close to downtown Olympia.

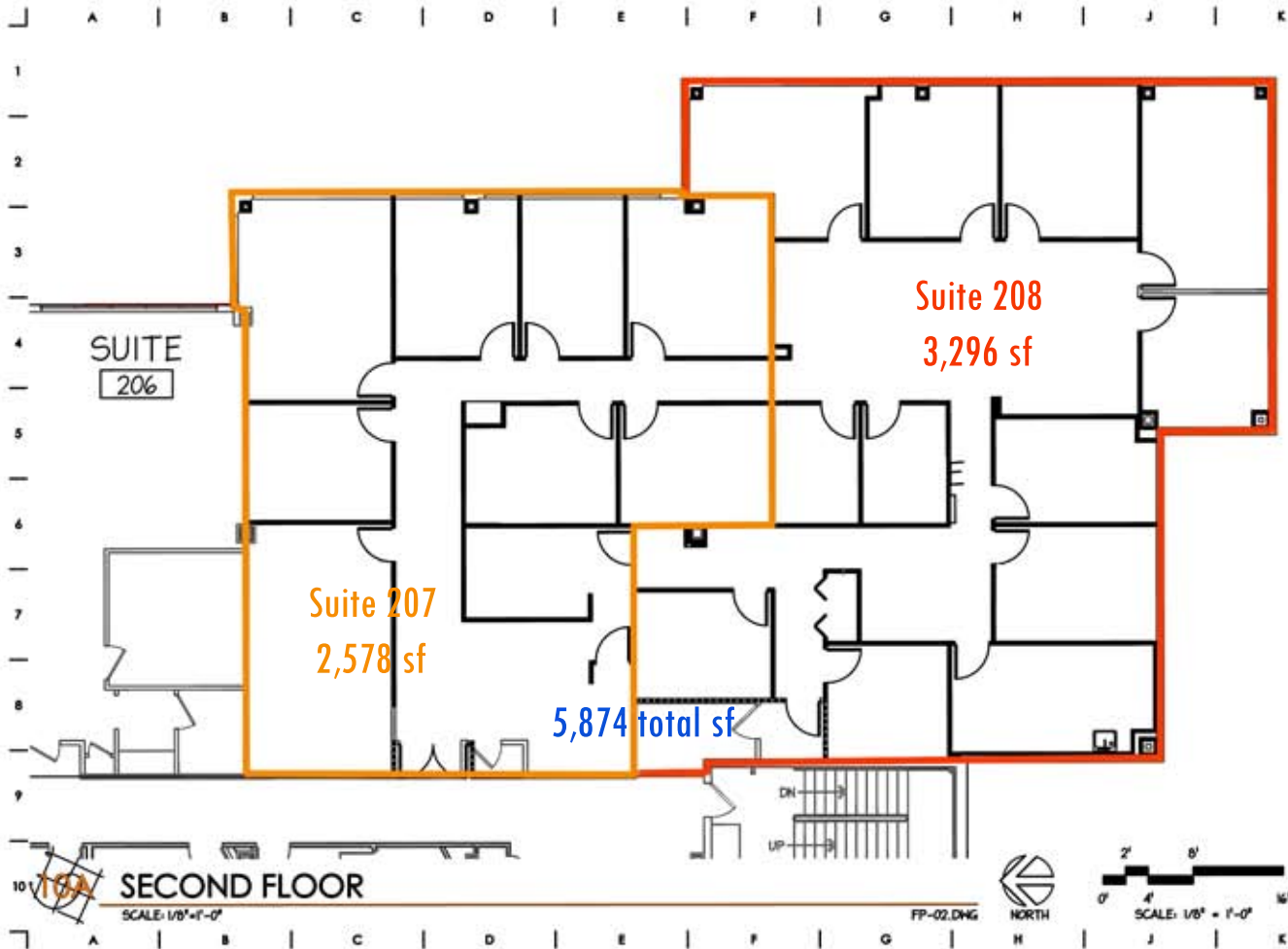

**Helix**  
 design group  
 2 821 12th St. E Suite 201  
 Tacoma, WA 98504  
 Tel: 253.922.9037  
 Fax: 253.922.4499



**NOT FOR CONSTRUCTION**

SKYTH  
 LANDING  
 7 SECOND FLOOR  
 SUITE 207/208 SPLIT  
 OLYMPIA, WA

NO.	DESCRIPTION	DATE
1	ISSUED FOR PERMIT	
2	ISSUED FOR CONSTRUCTION	
3	ISSUED FOR CONSTRUCTION	
4	ISSUED FOR CONSTRUCTION	
5	ISSUED FOR CONSTRUCTION	
6	ISSUED FOR CONSTRUCTION	
7	ISSUED FOR CONSTRUCTION	
8	ISSUED FOR CONSTRUCTION	
9	ISSUED FOR CONSTRUCTION	
10	ISSUED FOR CONSTRUCTION	

**A001**



This information, while obtained from sources we deem reliable, is not guaranteed. It is provided without any representation, warranty or guarantee, expressed or implied as to its accuracy. Prospective buyer or tenant should conduct an independent investigation and verification of all matters deemed to be material including, but not limited to, statements of income and expenses. Consult your attorney or other professional advisor.